

MNR.  $\phi$ .2617/.2672  
M8 X 1.25 - 6G X .270 DP  
P.  $\phi$ .2830/.2869  
 $\phi$ .330 X 90° CHAMFERL

INSTALLED DEPTH OF B.E. 8MM FTGS - .210

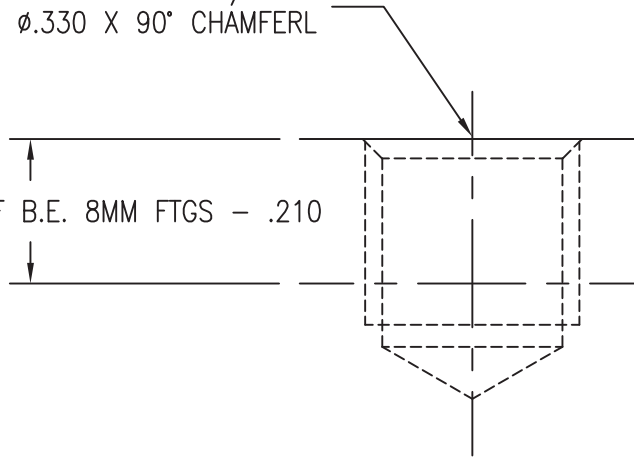

PORT DETAIL - M8 X 1.25 - 6G THD.

REV	NO.	CHANGE	APP	DATE	REV	NO.	CHANGE	APP	DATE	SCALE: N.T.S.	APPROVED BY:	DRAWN: GAT
										DATE: 02/24/14		
<p>ALL DIMENSIONS IN INCHES UNLESS OTHERWISE NOTED  TOLERANCES UNLESS OTHERWISE SPECIFIED:  DECIMAL: <math>\pm</math> .005 FRACTIONAL: <math>\pm</math> 1/64 ANGULAR: <math>\pm</math> 1/2</p>											REV.	
<p>SURFACE FINISH UNLESS OTHERWISE SPECIFIED: 125/√</p>										USED ON DRAWING NO:	DRAWING NO:	



beswick engineering co., inc.  
greenland, new hampshire 03840

this drawing and all novel ideas contained in or suggested thereby, in whole or in part, are the property of Beswick Engineering Co., Inc. and are not to be reproduced or used without written permission.